

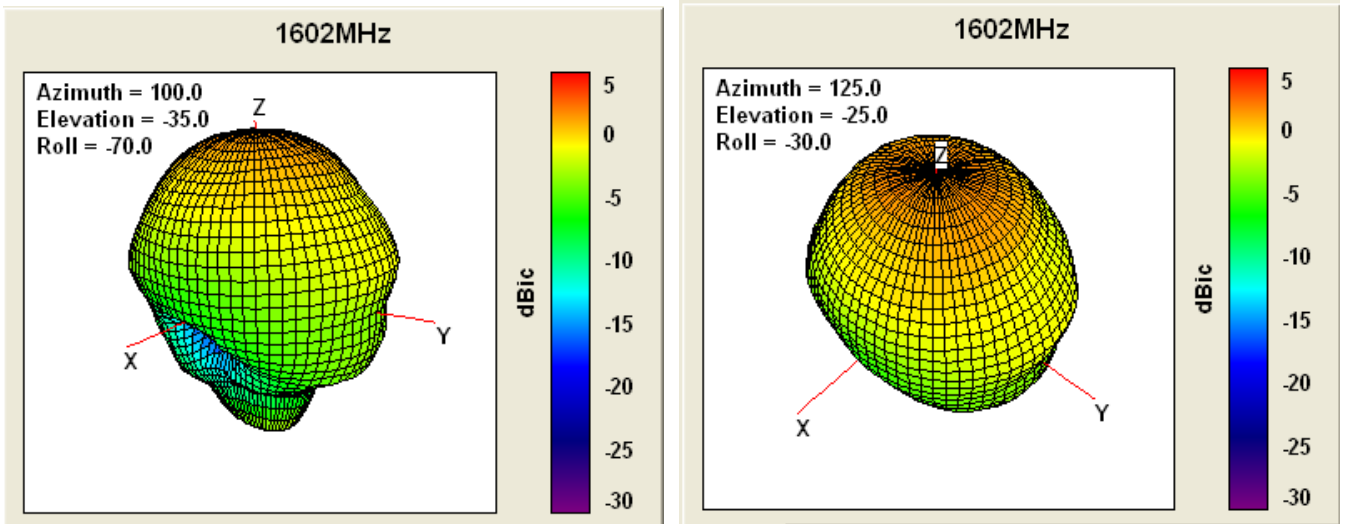

2.2 Gain Pattern (Unit : dBic)

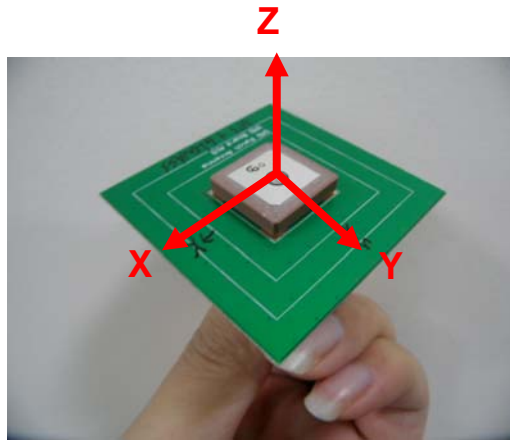
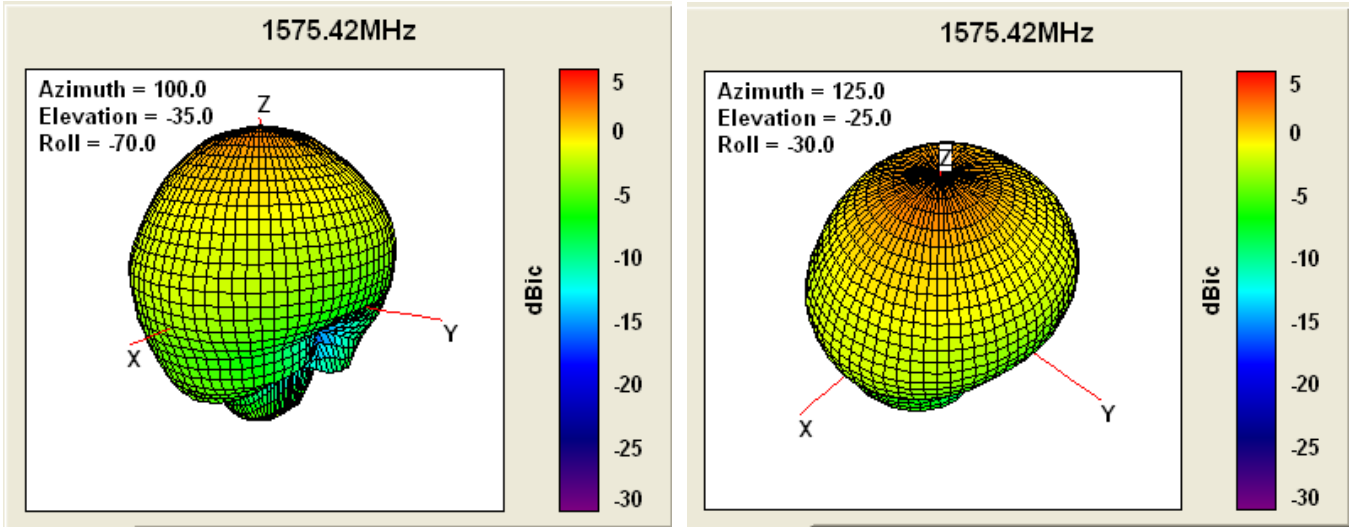

UNLESS OTHER SPECIFIED TOLERANCES ON :

X=±	X.X=±	X.XX=±
ANGLES=±		HOLEDIA=±
SCALE :	UNIT : mm	
DRAWN BY: 羅孟仙	CHECKED BY: 鄭大福	
DESIGNED BY: 李守仁	APPROVED BY: 曾源標	
TITLE : PA1590MS4G-102-1S ENGINEERING SPECIFICATION		

	INPAQ TECHNOLOGY CO., LTD.	
	<small>THIS DRAWINGS AND SPECIFICATIONS ARE THE PROPERTY OF INPAQ TECHNOLOGY CO.,LTD.AND SHALL NOT BE REPRODUCED OR USED AS THE BASIS FOR THE MANUFACTURE OR SALE OF APPARATUS OR DEVICES WITHOUT PERMISSION</small>	
DOCUMENT NO.	ENS000049520	SPEC REV. P1

3. Typical Electrical Properties

Characteristics	Specification	Unit	Conditions
Center Frequency	1584.8±2.0	MHz	By Test Ground Plane
Polarization	RHCP		By Test Housing
S11	< -20	dB	By Test Ground Plane
Frequency Temperature Coefficient	0±20	ppm/°C	-40°C to +85°C

PA1590MS4G-102-1S , G : Green parts (RoHS compliance)

-102 are the code of project number, -1S show of appendix

4. Dimension

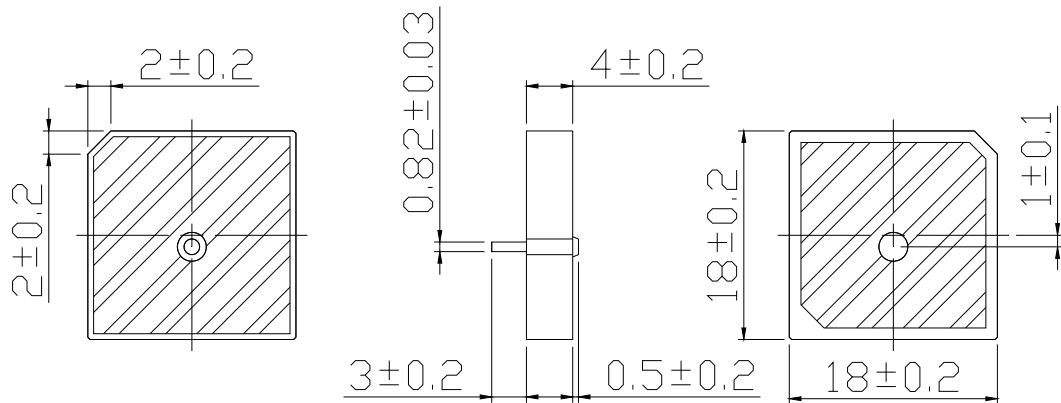

Unit: mm

UNLESS OTHER SPECIFIED TOLERANCES ON :

X=± X.X=± X.XX=±

ANGLES=± HOLEDIA=±

SCALE : UNIT : mm

DRAWN BY: 羅孟仙 CHECKED BY: 鄭大福

DESIGNED BY: 李守仁 APPROVED BY: 曾源標



INPAQ TECHNOLOGY CO., LTD.

THIS DRAWINGS AND SPECIFICATIONS ARE THE PROPERTY OF INPAQ TECHNOLOGY CO.,LTD.AND SHALL NOT BE REPRODUCED OR USED AS THE BASIS FOR THE MANUFACTURE OR SALE OF APPARATUS OR DEVICES WITHOUT PERMISSION

TITLE : PA1590MS4G-102-1S
ENGINEERING SPECIFICATION

DOCUMENT NO.

ENS000049520

SPEC REV.
P1

5. Test Condition Ground Plane

PA1590MS4G-102-1S-V1

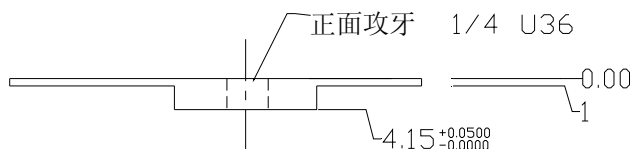
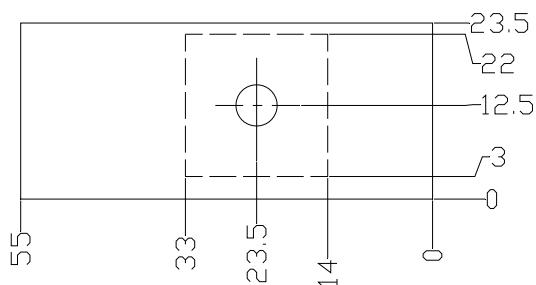

Unit: mm

6. Return Loss Characteristics

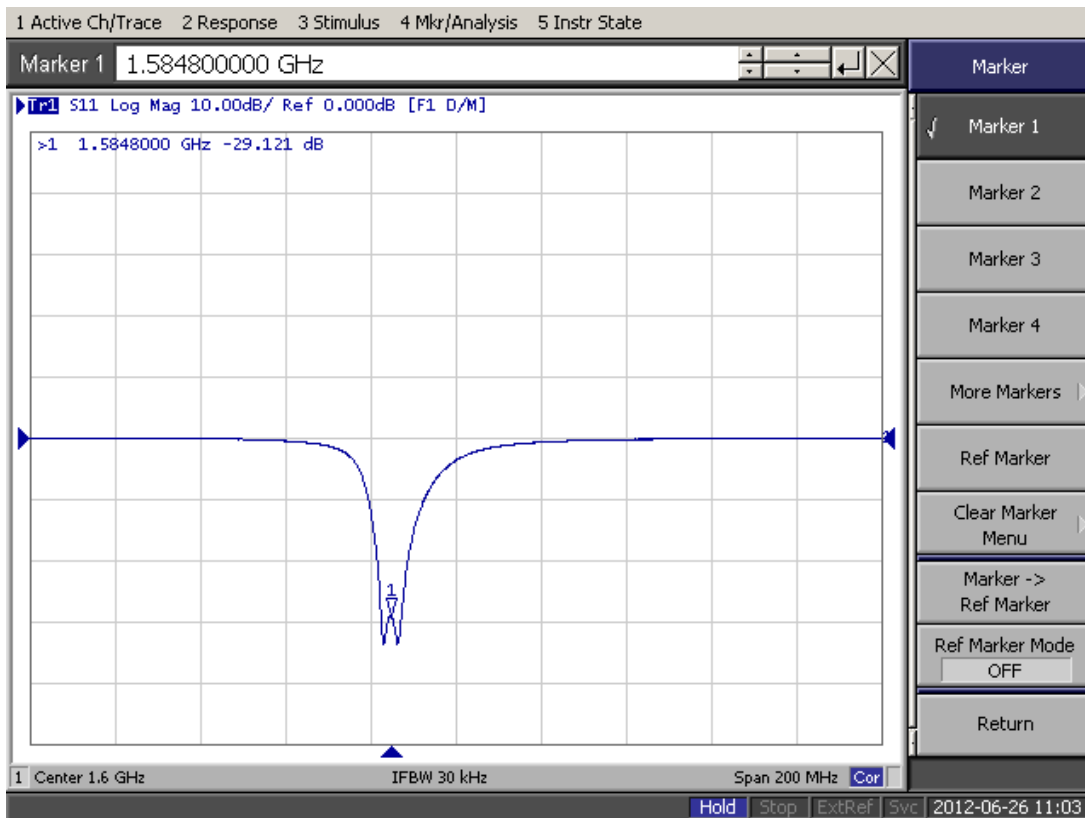

UNLESS OTHER SPECIFIED TOLERANCES ON :	
X=±	X.X=±
ANGLES=±	HOLEDIA=±
SCALE :	UNIT : mm
DRAWN BY: 羅孟仙	CHECKED BY: 鄭大福
DESIGNED BY: 李守仁	APPROVED BY: 曾源標
TITLE : PA1590MS4G-102-1S ENGINEERING SPECIFICATION	



INPAQ TECHNOLOGY CO., LTD.

THIS DRAWINGS AND SPECIFICATIONS ARE THE PROPERTY OF INPAQ TECHNOLOGY CO.,LTD.AND SHALL NOT BE REPRODUCED OR USED AS THE BASIS FOR THE MANUFACTURE OR SALE OF APPARATUS OR DEVICES WITHOUT PERMISSION

DOCUMENT NO.	ENS000049520	SPEC REV.
		P1

7. Measured Input Impedance on a Smith Chart

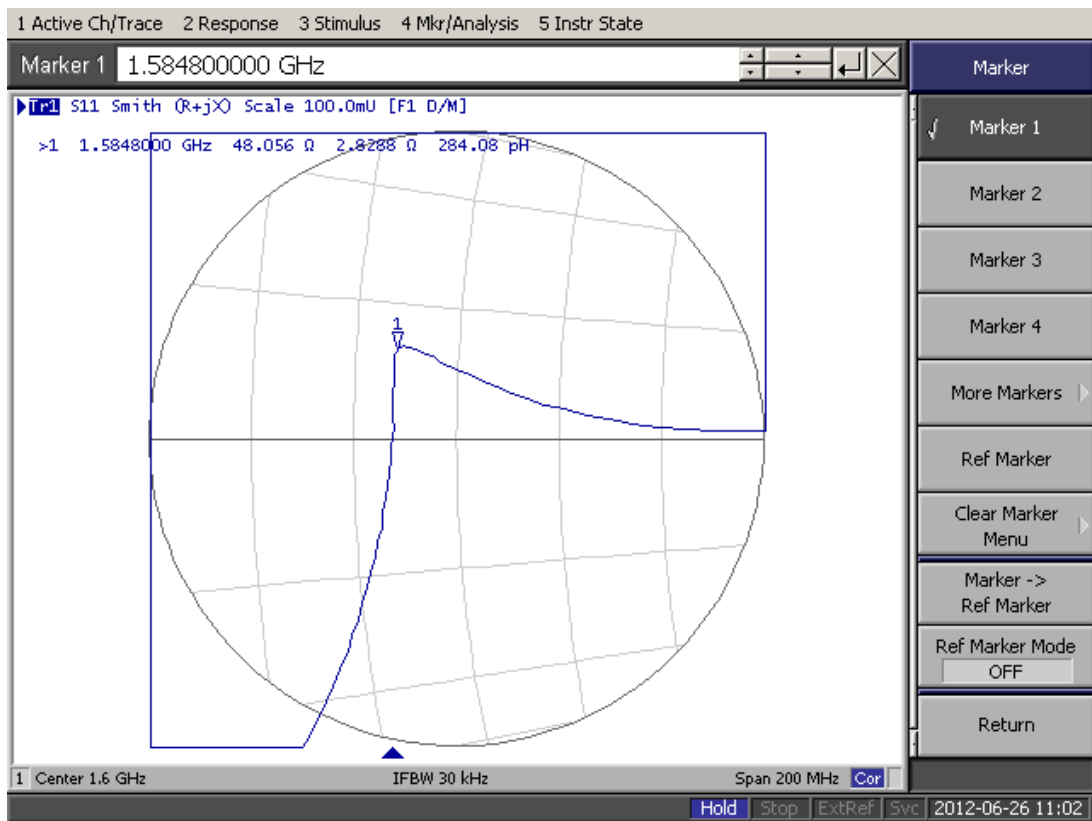
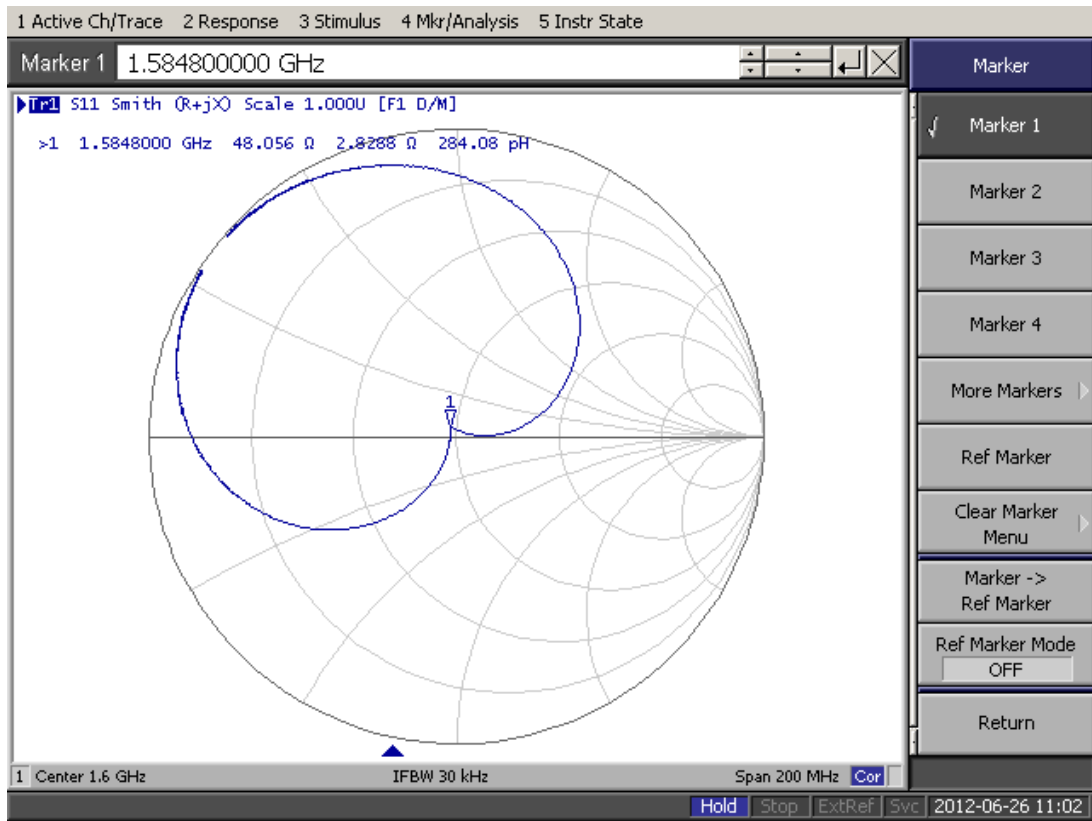

UNLESS OTHER SPECIFIED TOLERANCES ON :	
X=±	X.X=±
ANGLES=±	HOLEDIA=±
SCALE :	UNIT : mm
DRAWN BY: 羅孟仙	CHECKED BY: 鄭大福
DESIGNED BY: 李守仁	APPROVED BY: 曾源標
TITLE : PA1590MS4G-102-1S ENGINEERING SPECIFICATION	



INPAQ TECHNOLOGY CO., LTD.

THIS DRAWINGS AND SPECIFICATIONS ARE THE PROPERTY OF INPAQ TECHNOLOGY CO.,LTD.AND SHALL NOT BE REPRODUCED OR USED AS THE BASIS FOR THE MANUFACTURE OR SALE OF APPARATUS OR DEVICES WITHOUT PERMISSION

DOCUMENT NO.	ENS000049520	SPEC REV.
		P1

