

SMD Semi-Shielded Power Inductor - SNR252012 Series **Meisongbei**



Features

- 2.5mmx2.0mmx1.25mm Shielded
- Inductance Range: 0.24uH - 22uH
- Current Range: 0.5A - 4.05A
- Small and very Thin inductor

Application

- LED Lighting,
- Automotive systems,
- Notebooks, desktop computers, servers, graphic cards.

General Specifications

- Storage temp range: -40°C to +85°C
- Operating temp range: -40°C to +125°C
- Resistance to Soldering Heat +260°C for 5-10 Sec.

► Dimensions & Configurations (Unit:mm)

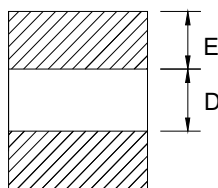
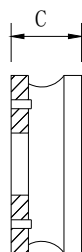
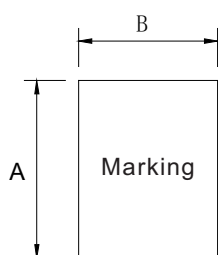

Recommended Layout

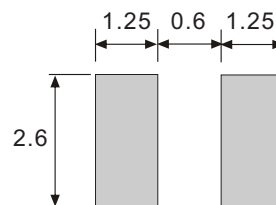

Type	A	B	C	D	E
SNR252012	2.5±0.3	2.0±0.35	1.25Max	1.0±0.2	0.8±0.2

► Electrical Characteristics For SNR252012 Series

Part Number	Inductance [uH]	DCR(max) [mΩ]	Isat [A] (Max.)
SNR252012-R24N	0.24±30%	32	4.05
SNR252012-R47N	0.47±30%	42	3.60
SNR252012-R68N	0.68±30%	55	2.70
SNR252012-1R0N	1.0±30%	63.7	2.45
SNR252012-1R5N	1.5±30%	84	2.05
SNR252012-2R2N	2.2±30%	115.2	1.90
SNR252012-3R3M	3.3±20%	156	1.50
SNR252012-4R7M	4.7±20%	228.8	1.35
SNR252012-6R8M	6.8±20%	325	1.00
SNR252012-120M	10±20%	492	0.75
SNR252012-150M	15±20%	648	0.56
SNR252010-220M	22±20%	1020	0.50

- Inductance tested at 100kHz, 1.0Vrms, 0.0Adc
- Heat Rating Current (Irms): Current that cause the temperature 40°C rise from 25°C
- Saturation Current (Isat): DC current at which the inductance drops 30% from its value without current