

1 2 3 4 5 6 7 8 9

F
E
D
C
B
A

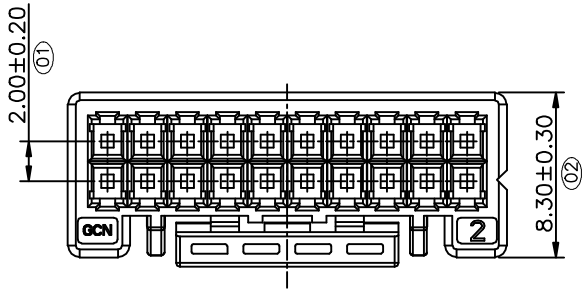

No. of circuits	Dimension Information		
	M	L	L1
2x4pin	6.00	10.00	8.70
2x5pin	8.00	12.00	10.70
2x6pin	10.00	14.00	12.70
2x7pin	12.00	16.00	14.70
2x8pin	14.00	18.00	16.70
2x9pin	16.00	20.00	18.70
2x10pin	18.00	22.00	20.70
2x20pin	38.00	42.00	40.70

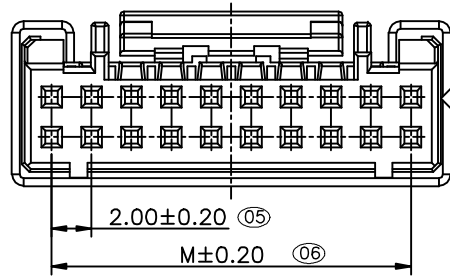
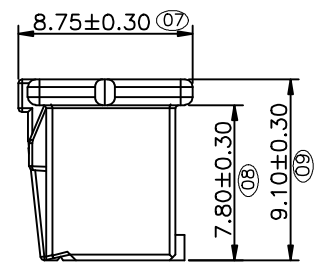
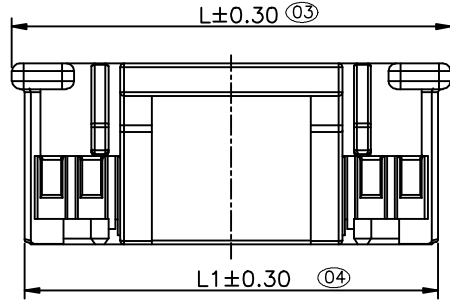
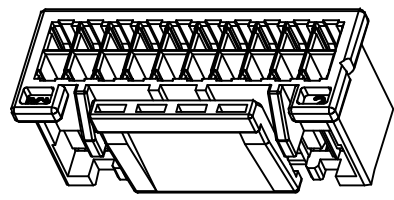

Specifications
 Voltage rating:250V AC/DC
 Current Rating:3Amp
 Insulation Resistance:1000MΩMin.
 Dielectric Withstanding Voltage:800VAC
 Operating Temperature:-25°C to +85°C
 Material:
 Regular Thermoplastic: Only Suitable for Wave Soldering Process (PBT).
 All materials must meet Greenconn requirement for environment protection.

 Website:www.greenconn.com E-mail:sales@greenconn.com			3RD.ANG PROJ.	GENERAL TOLERANCE		DESIGNED: CHECKED: APPROVED:	DATE: DATE: DATE:	DWG NO.	TITLE.
				X.±3.0'	X.±0.30			GWF192-HA-N	
REV.	UNIT.	SCALE.	PAGE.	.X'±2.0' .XX'±1.0' .XXX'±0.5'	.X±0.25 .XX±0.15 .XXX±0.10	PART NO. GWF192-XXAAJ-N		Pitch 2.00mm Housing/ 2*10PIN	
E	mm	1:3							

1 2 3 4 5 6 7 8 9

1 2 3 4 5 6 7 8 9

< 2x4pin >

< 2x5pin >

< 2x6pin >

F

E

D

C

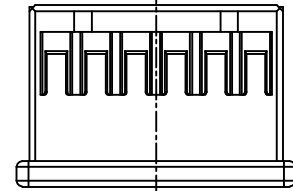
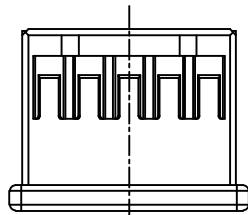
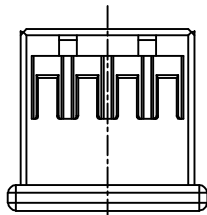
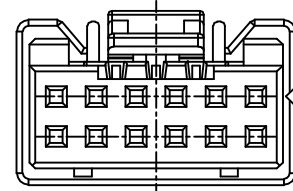
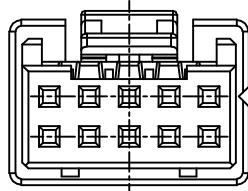
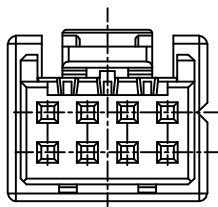

F

E

D

C

B

B

A

A

Website: www.greenconn.com
E-mail: sales@greenconn.com

3RD.ANG
PROJ.

GENERAL TOLERANCE	
X. ±3.0'	X. ±0.15
.X ±2.0'	.X ±0.10
.XX ±1.0'	.XX ±0.05
.XXX ±0.5'	.XXX ±0.03

DESIGNED:
CHECKED:
APPROVED:

DATE:
DATE:
DATE:

DWG NO.
GWF192-HA-N
PART NO.
GWF192-XXAAJ-N

TITLE.
HOUSING FOR PITCH
2.00mm WIRE TO
BOARD CONNECTOR

REV. E	UNIT. mm	SCALE. 2:1	PAGE. 2/4
--------	----------	------------	-----------

1 2 3 4 5 6 7 8 9

1 2 3 4 5 6 7 8 9

< 2x7pin >

< 2x8pin >

< 2x9pin >

F

E

D

C

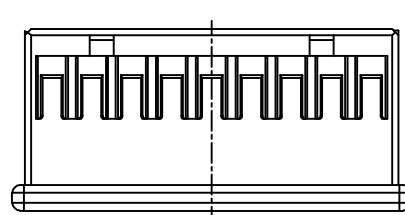
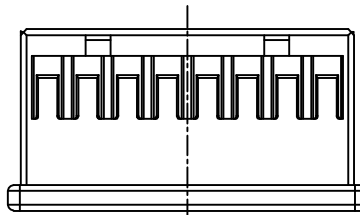
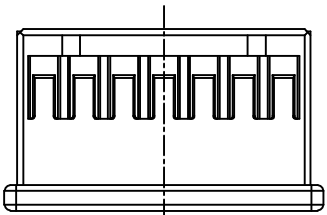
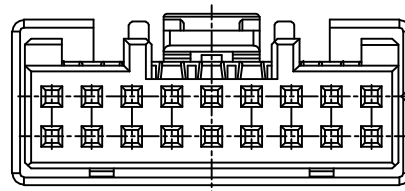
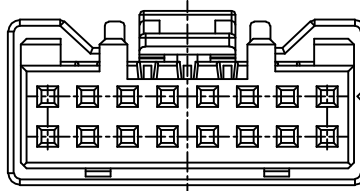
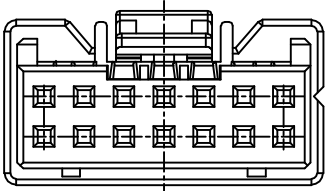

F

E

D

C

B

B

A

A



Website: www.greenconn.com
E-mail: sales@greenconn.com

REV. E	UNIT. mm	SCALE. 2:1
--------	----------	------------

3RD.ANG PROJ.

PAGE. 3/4

GENERAL TOLERANCE

X. ±3.0'	X. ±0.15
.X ±2.0'	.X ±0.10
.XX ±1.0'	.XX ±0.05
.XXX ±0.5'	.XXX ±0.03

DESIGNED:
CHECKED:
APPROVED:

DATE:
DATE:
DATE:

DWG NO. GWF192-HA-N
PART NO. GWF192-XXAAJ-N

TITLE.
HOUSING FOR PITCH 2.00mm WIRE TO BOARD CONNECTOR

1 2 3 4 5 6 7 8 9

1 2 3 4 5 6 7 8 9

< 2x10pin >

< 2x20pin >

F

E

D

C

B

A

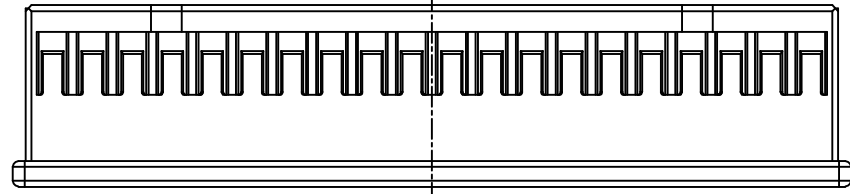
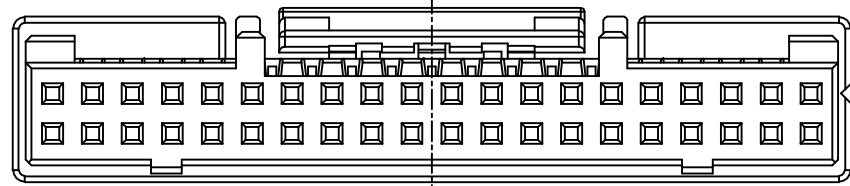
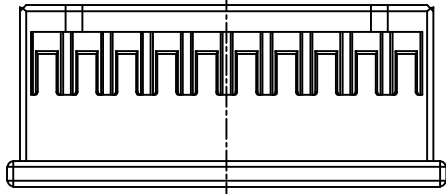
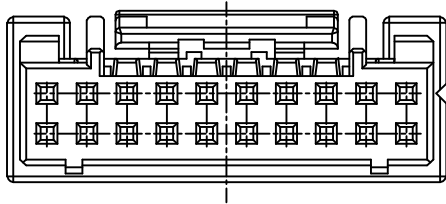

F

E

D

C

B

A



Website: www.greenconn.com
E-mail: sales@greenconn.com

REV. E	UNIT. mm	SCALE. 2:1
--------	----------	------------

3RD.ANG
PROJ.



PAGE. 4/4

GENERAL TOLERANCE

X. ±3.0'	X. ±0.15
.X' ±2.0'	.X ±0.10
.XX' ±1.0'	.XX ±0.05
.XXX' ±0.5'	.XXX ±0.03

DESIGNED:

CHECKED:

APPROVED:

DATE:

DATE:

DATE:

DWG NO.

GWF192-HA-N

PART NO.

GWF192-XXAAJ-N

TITLE.

HOUSING FOR PITCH
2.00mm WIRE TO
BOARD CONNECTOR

1

2

3

4

5

6

7

8

9