

REV.	ECN NO./DESCRIPTION	DATE
A	R180414	03/12'21
B	R180414	06/16'21
C	R180414	09/09'22

GENERAL TOLERANCES UNLESS SPECIFIED		PART NO.	<b>LOTES</b>		
SEE TABLE		SEE TABLE			
.X ± 0.35	X° ± 3°	APPROVED BY	TITLE		
.XX ± 0.25	.X° ± 2°	Mark Zhang	DDR4 SMT 288 PIN CONN.		
.XXX ± 0.15	.XX° ± 1°	CHECKED BY	DWG NO.		
CUSTOMER DRAWING		Hongxing Xu	GAP-ADDR0381-53		
SIZE	UNITS	DRAWN BY	SHEET	SCALE	REV
A4	MM [INCH]	Zhijie Li			

REV.	ECN NO./DESCRIPTION	DATE
A	R180414	03/12'21
B	R180414	06/16'21
C	R180414	09/09'22

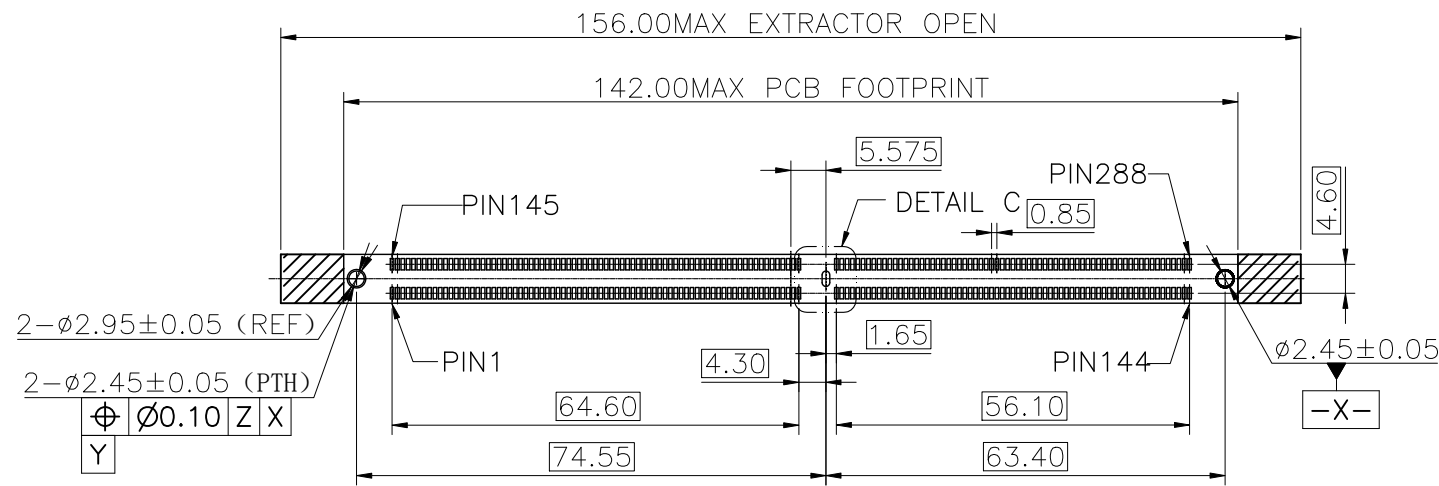

RECOMMENDED PCB LAYOUT(CONNECTOR SIDE)(TOL.:±0.05)

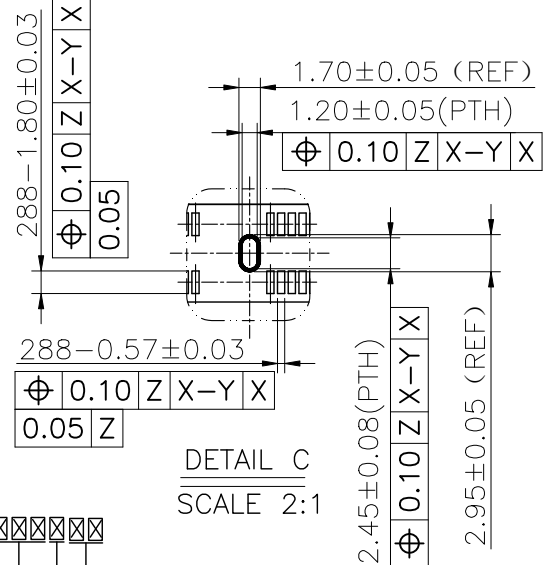

DETAIL C  
SCALE 2:1

10.PRODUCT NUMBER NOTE:

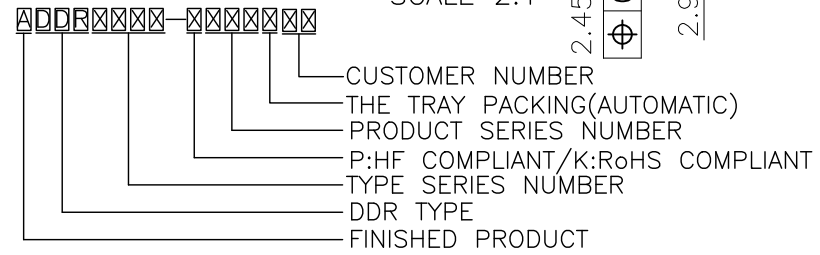

11.RECOMMENDED STENCIL DIMENSIONS FOR DDR4 SMT:

REFLOW CONDITION	THICKNESS OF STENCIL
AIR	0.18MM MIN
NITROGEN	0.18MM MIN
REWORK	0.20MM MIN

NOTES:

- MATERIAL: 1-1. HOUSING: HIGH TEMPERATURE THERMOPLASTIC , UL94V-0, COLOR: SEE TABLE.  
1-2. EJECTOR: HIGH TEMPERATURE THERMOPLASTIC, UL94V-0, COLOR: SEE TABLE.  
1-3. CONTACT: SPECIFIC COPPER  
1-4. HOOK: BRASS
- FINISH: CONTACT: 50u" NICKEL UNDERPLATED ;  
100u" MIN MATTE TIN PLATED ON SOLDER AREA.  
GOLD PLATING ON CONTACT AREA (SEE TABLE) .  
HOOK:100u" MIN MATTE TIN PLATED ON SOLDER AREA.  
50u" MIN NICKEL UNDERPLATED.
- DATE CODE: \*\*\*\*  
WEEK  
YEAR
- MECHANICAL CHARACTERISTICS:  
4-1.CONTACT RETENTION FORCE:0.30Kgf MIN. PER PIN.  
4-2.DURABILITY:25 CYCLES
- ELECTRICAL CHARACTERISTICS:  
5-1.CONTACT CURRENT RATING:0.75 AMPS MAX.  
5-2.INSULATION RESISTANCE: 1MEGOHMS MIN. AT 500VDC.  
5-3.DIELECTRIC WITHSTANING VOLTAGE: 500V AC AT SEA LEVEL.  
5-4.LOW LEVEL CONTACT RESISTANCE:INITIAL:10MILLIOHMS MAX. FINAL:20 MILLIOHMS MAX.
- RECOMMENDED PROCESS:  
THE PEAK TEMPERATURE ON THE BOARD SHALL  
BE MAINTAINED FOR 10±0.5 SECONDS AT 260±5°C.
- STORAGE ENVIRONMENT FOR CONNECTOR:  
1. ALL THE MATERIALS SHOULD BE USED UP IN 72 HOURS THE PACKAGE IS OPEN;
- RECOMMENDED MODULE LAYOUT SHOULD BE MO-309C FROM JEDEC.
- RoHS OR HF COMPLIANT.

GENERAL TOLERANCES UNLESS SPECIFIED		PART NO.	<b>LOTES</b>		
.X ± 0.35	X.° ± 3°	SEE TABLE	TITLE DDR4 SMT 288 PIN CONN.		
.XX ± 0.25	X.° ± 2°	APPROVED BY Mark Zhang	DWG NO. GAP-ADDR0381-53		
.XXX ± 0.15	.XX° ± 1°	CHECKED BY Hongxing Xu	SHEET SCALE REV 2 / 5 5:4 C		
SIZE	UNITS	DRAWN BY Zhijie Li			
A4	MM [INCH]				

REV.	ECN NO./DESCRIPTION	DATE
A	R180414	03/12'21
B	R180414	06/16'21
C	R180414	09/09'22

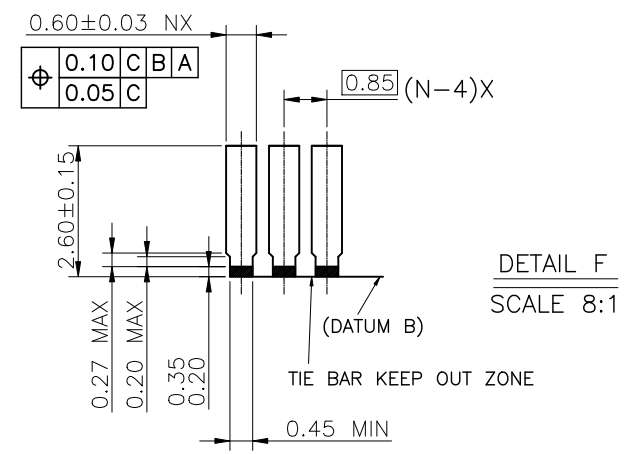
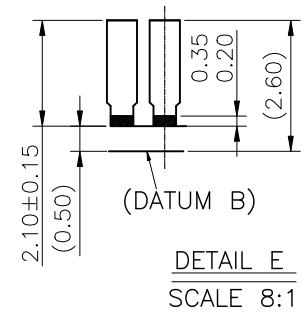
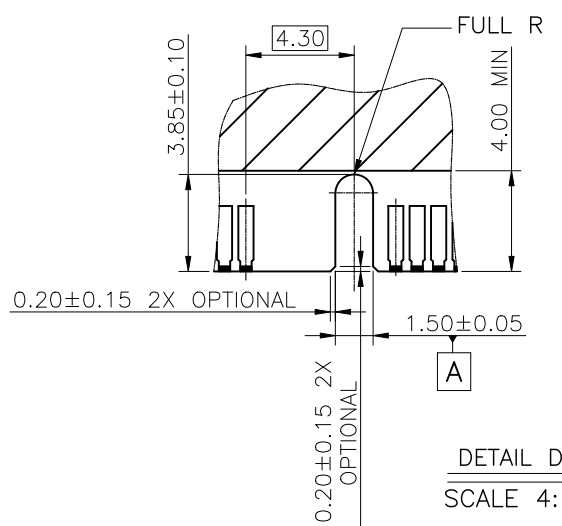
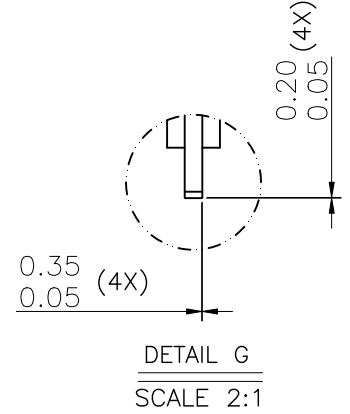
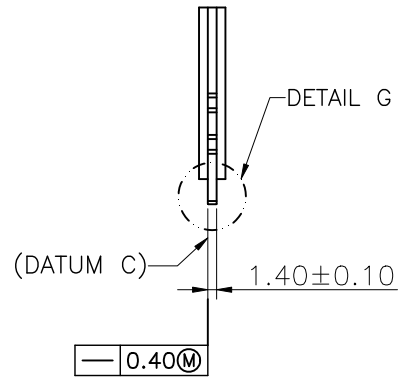
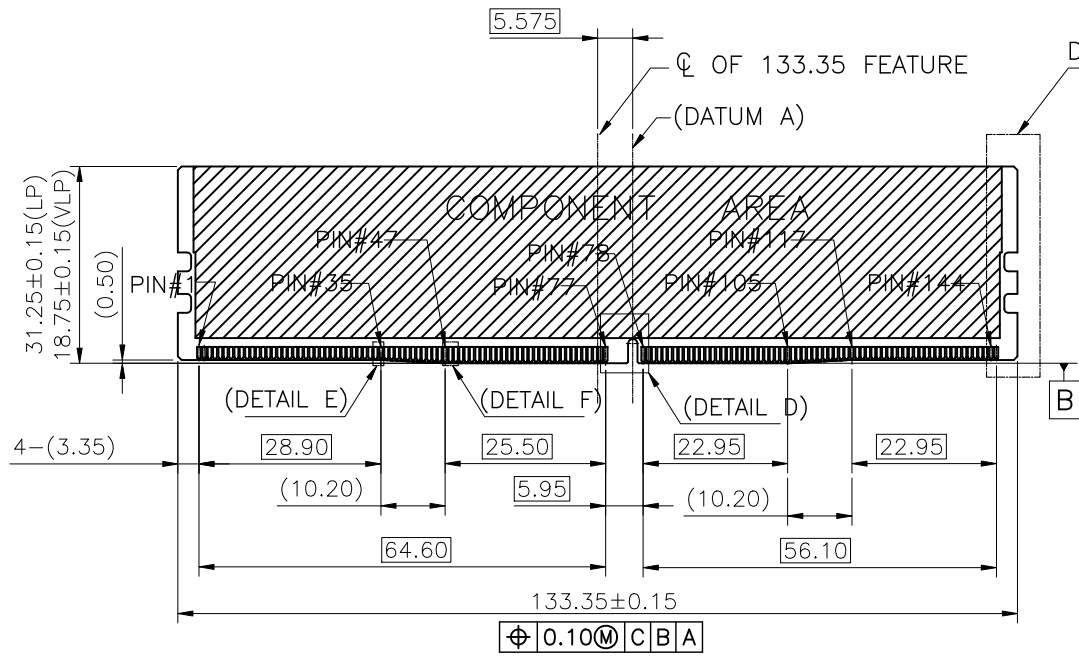

GENERAL TOLERANCES UNLESS SPECIFIED		PART NO.	<b>LOTES</b>		
.X ± 0.35	X.° ± 3°	SEE TABLE			
.XX ± 0.25	X.° ± 2°	APPROVED BY	TITLE		
.XXX ± 0.15	.XX° ± 1°	Mark Zhang	DDR4 SMT 288 PIN CONN.		
CUSTOMER DRAWING		CHECKED BY	DWG NO.		
		Hongxing Xu	GAP-ADDR0381-53		
SIZE	UNITS	DRAWN BY	SHEET	SCALE	REV
A4	MM[INCH]	Zhijie Li			

REV.	ECN NO./DESCRIPTION	DATE
A	R180414	03/12'21
B	R180414	06/16'21
C	R180414	09/09'22

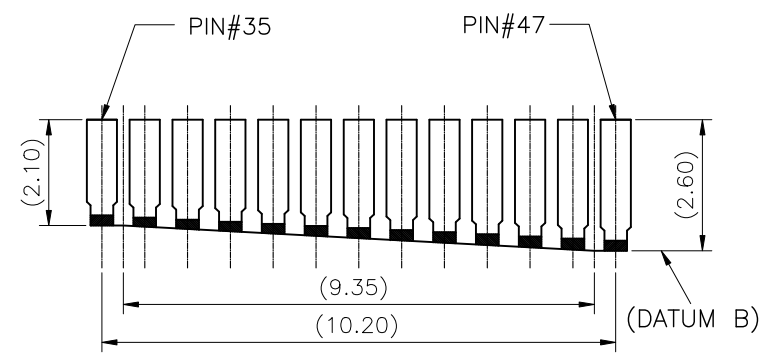
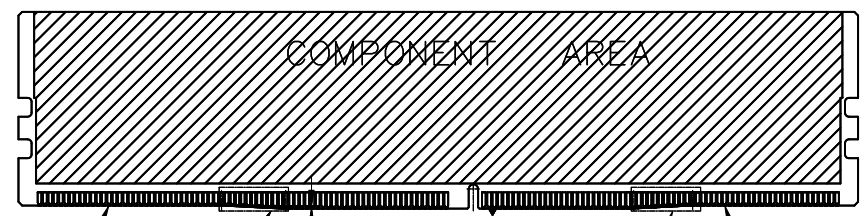

DETAIL I  
SCALE 8:1

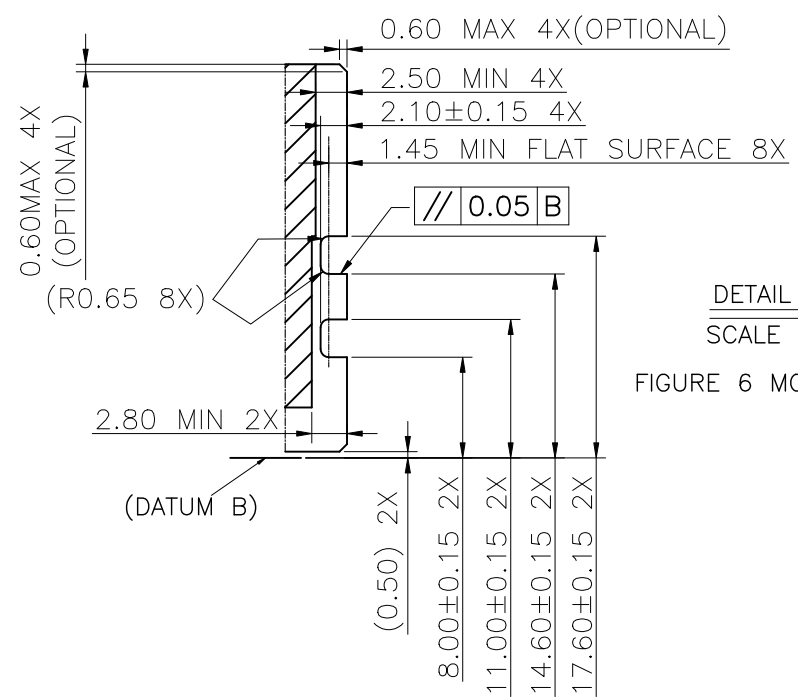

DETAIL H  
SCALE 2:1  
FIGURE 6 MODULE OUTLINE

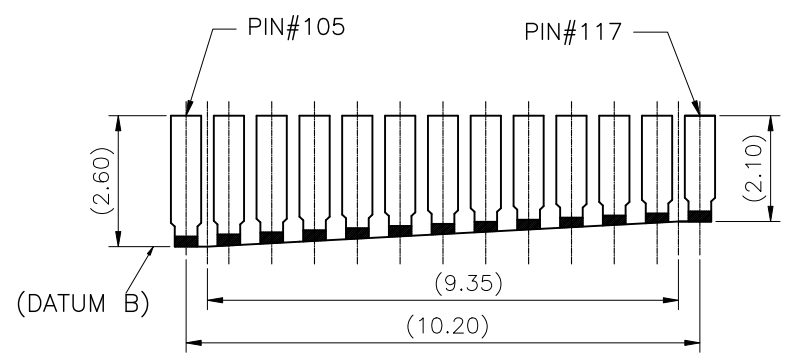

DETAIL J  
SCALE 8:1  
FIGURE 7 STEP AND RAMP DIMENSIONS

GENERAL TOLERANCES UNLESS SPECIFIED		PART NO.	<b>LOTES</b>		
.X ± 0.35	X.° ± 3°	SEE TABLE			
.XX ± 0.25	.X.° ± 2°	APPROVED BY	TITLE		
.XXX ± 0.15	.XX.° ± 1°	Mark Zhang	DDR4 SMT 288 PIN CONN.		
CUSTOMER DRAWING		CHECKED BY	DWG NO.		
		Hongxing Xu	GAP-ADDR0381-53		
SIZE	UNITS	DRAWN BY	SHEET	SCALE	REV
A4	MM[INCH]	Zhijie Li			

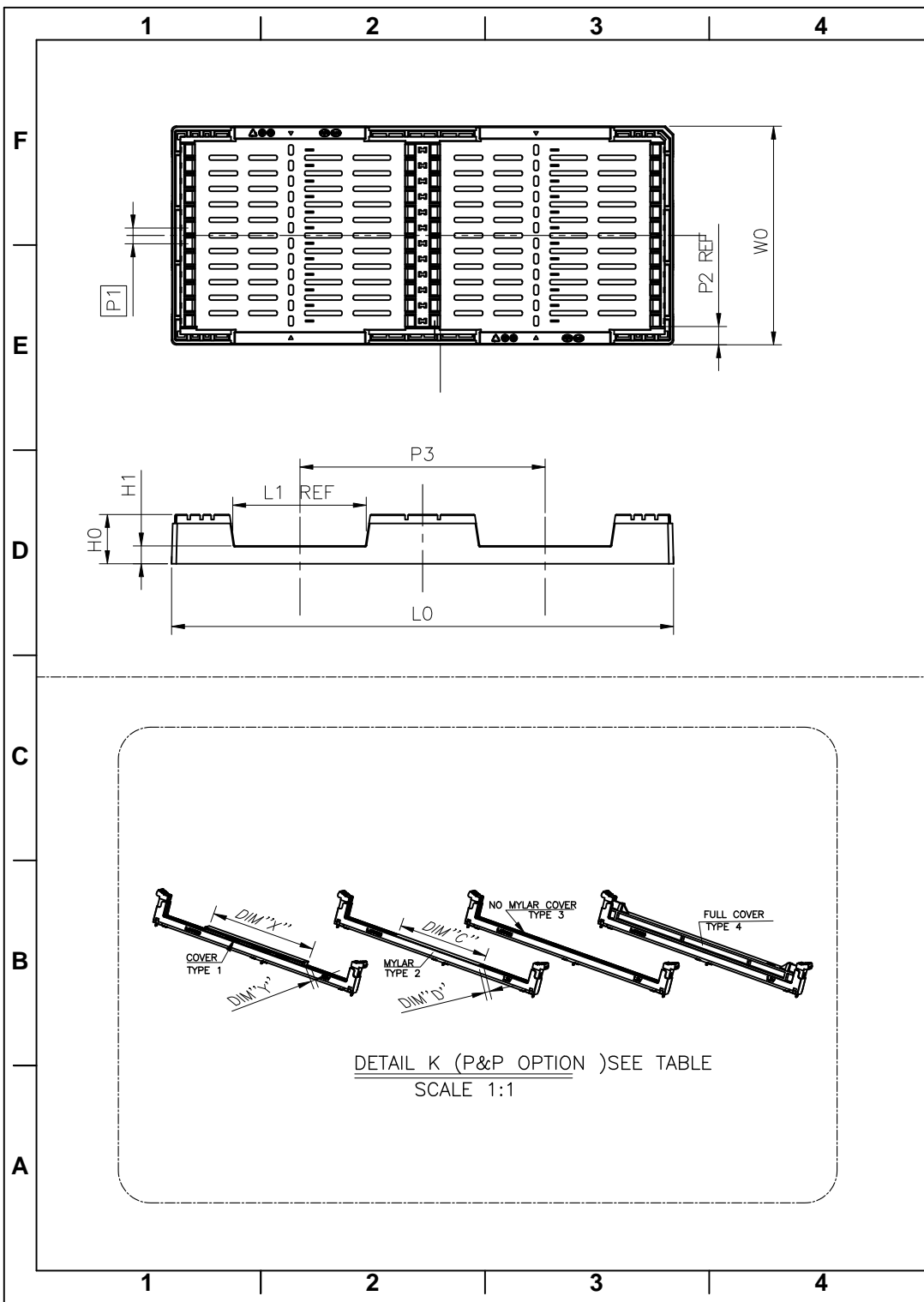

REV.	ECN NO./DESCRIPTION	DATE
A	R180414	03/12'21
B	R180414	06/16'21
C	R180414	09/09'22

PUT THE TRAY INTO CARTON

P/N	L0	L1	W0	H0	H1	P1	P2	P3	CARTON Q'TY
TRAY-P01	310		135	30.43		9.60		151.40	24PCS/TRAY*20=480

GENERAL TOLERANCES UNLESS SPECIFIED		PART NO.	<b>LOTES</b>		
.X ± 0.35	X.° ± 3°	SEE TABLE	TITLE		
.XX ± 0.25	X.° ± 2°	APPROVED BY	DDR4 SMT 288 PIN CONN.		
.XXX ± 0.15	.XX° ± 1°	Mark Zhang	DWG NO.		
CUSTOMER DRAWING	CHECKED BY	Hongxing Xu	GAP-ADDR0381-53		
SIZE	UNITS	DRAWN BY	SHEET	SCALE	REV
A4	MM[INCH]	Zhijie Li			

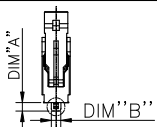
	Part NO.	Housing Colour	EJECTOR Colour	P&P Option				Board lock options			Contact plate	Tray	Remark
				Cover		Mylar		DIM"A"	DIM"B"	Hook type			
				DIM"X"	DIM"Y"	DIM"C"	DIM"D"						
1	ADDR0381-P130C	Black	Black	NA	NA	90	6.2	2.00	2.28		30u"	TRAY_P01	Type 2
2	ADDR0381-P132C	Blue	Blue						30u"				