

CR-2

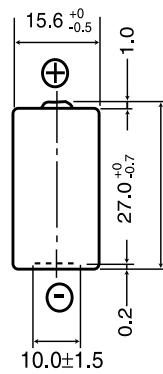

SPECIFICATIONS

Name	CR-2
Nominal voltage (V)	3
Nominal capacity (mAh)	850
Continuous drain (mA)	20
Operating temperature (°C)	-40 to +70*
Weight (g)	11.0

DISCHARGE TEMPERATURE CHARACTERISTICS

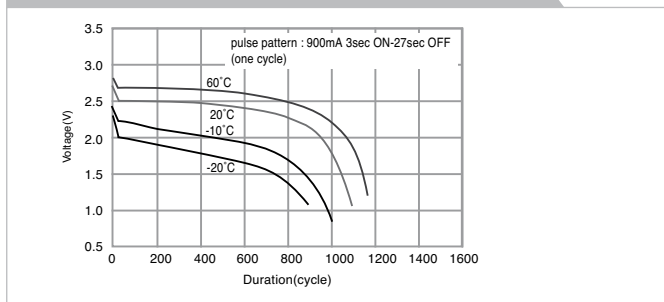

CR-123A

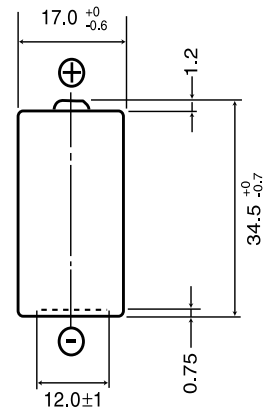

SPECIFICATIONS

Name	CR-123A
Nominal voltage (V)	3
Nominal capacity (mAh)	1,400
Continuous drain (mA)	20
Operating temperature (°C)	-40 to +70*
Weight (g)	17.0

DISCHARGE TEMPERATURE CHARACTERISTICS

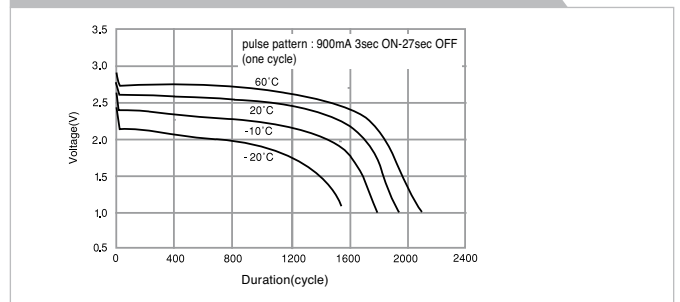

The data in this document are for descriptive purposes only and are not intended to make or imply any guarantee or warranty.

* Please consult Panasonic for use below and above -20°C to +60°C.