

Старый парт-номер Новый парт-номер
 CAP-WACPMLC2 => CAP-WACMTPC1

REV.	ECN NO.	DATE	SIGN	DESCRIPTION
B	LE312B0237	2012/11/15	Kevin Wang	Modify the Gasket

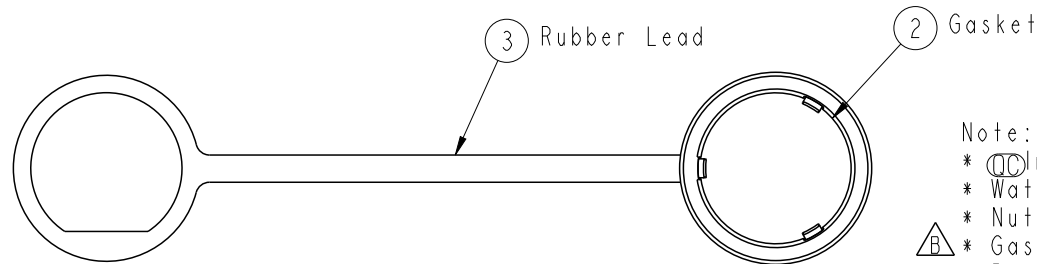

Note:
 * ⌀ Important Dimension.
 * Waterproof Rate: IP67
 * Nut: Nylon+GF, Black
 * Gasket: Silicone, Black
 * Rubber Lead: TPES Black
 * Screw: M2.5, Stainless Steel
 * Screw must not be too tightly screwed.
 (Chain should be able to revolve)

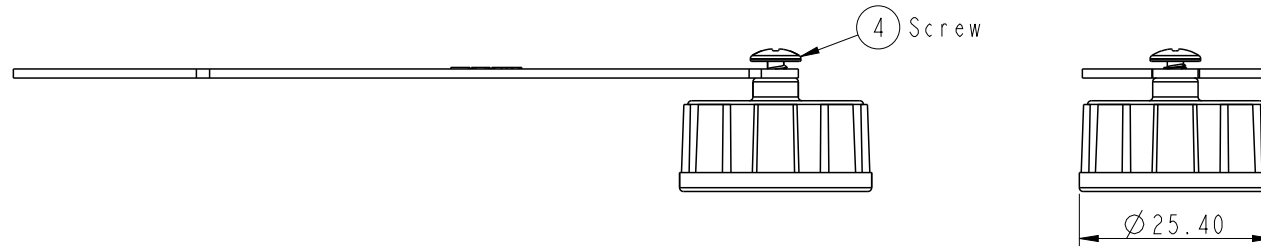
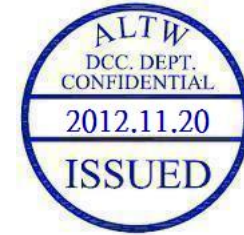
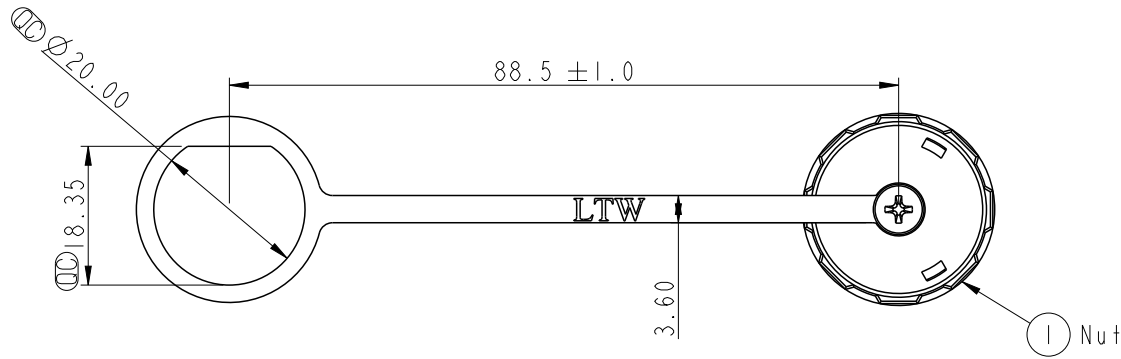
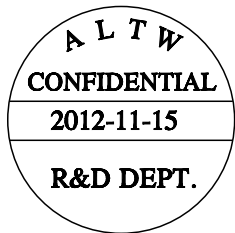

UNIT:mm

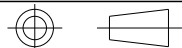

TOLERANCE
 .X ±0.25
 .XX ±0.1
 .XXX ±0.05
 ANGLES ±1°

TITLE Cap			
SCALE 1:2	SIZE A4	SHEET 1 OF 1	
REV. B	WC-REV. B.2	⌀ : Inspection item	

Amphenol LTW
 安費諾亮泰企業股份有限公司

ITEM NO CAP-WACPMLC2	DRAWN BY Kevin	DATE 2012-11-20
DWG NO CAP-WACPMLC2	CHECKED BY Doreen	DATE 2011-11-20
CUSTOMER ALTW	APPROVED BY Maslow	DATE 2011-11-20

THIS DOCUMENT IS SUBJECT TO CHANGE WITHOUT NOTICE. IT IS CONFIDENTIAL AND A PROPERTY OF AMPHENOL LTW. DISCLOSURE TO THIRD PARTY HAS TO BE AUTHORIZED BY AMPHENOL LTW.