

1 2 3 4 5 6 7 8

A

B

C

D

E

F

G

H

A

B

C

D

E

F

G

H

SPECIFICATION

Current Rating: 2A AC, DC
 Voltage Rating: 250V AC, DC
 Temperature Range: -25° C ~+85° C
 Contact Resistance: 5 m ohms Max.
 Insulation Resistance: 1,000M ohms Min.
 Withstanding Voltage: 800V AC/minute.
 Assembly Wire Range: 26-30AWG
 Assembly P.C.B. Thickness: 0.8-1.6MM
 Insulation O.D. : 1.4MM(Max.)
 Material: Brass
 Finish: Tin Plated
 Q' ty: 10,000pcs/Roll

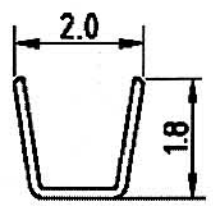
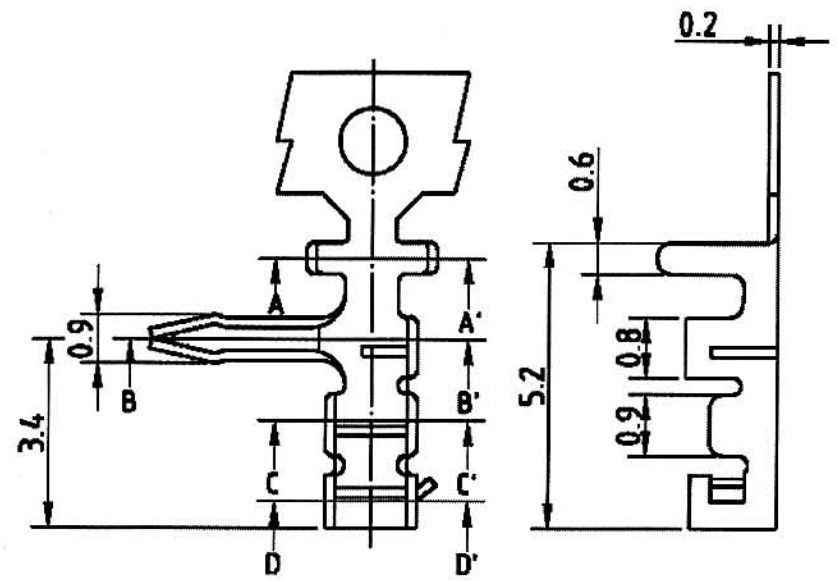

SECTION A-A'

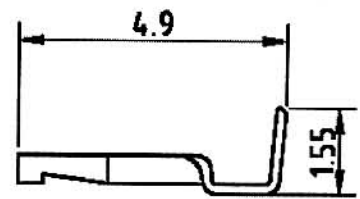

SECTION B-B'

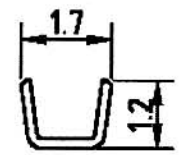

SECTION C-C'

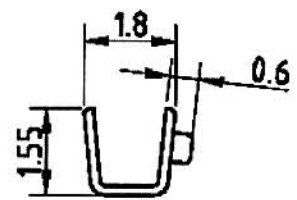

SECTION D-D'

玄茂科技股份有限公司
HSUAN MAO TECHNOLOGY CO., LTD.

UNIT		SCALE	PART NAME	
MM		2:1	SAN 2.0mm 90° TERMINAL	
APPD.	CKD.	TOLERANCE	PART NO.	REV.
		± 0.3	T2007-XBN00000	A

制表日: 2002/12/04

DRAWING.	APPROVED
<i>Jane</i>	

1 2 3 4 5 6 7 8